

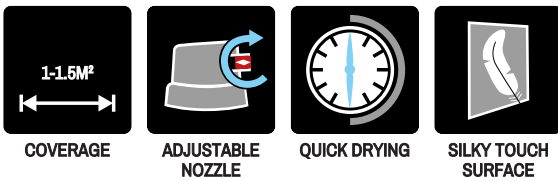

TERRACOTTA EFFECT



Easy-to-use and well covering Maston TerraCotta Effect spray paint gives your project a rich, sun-baked glow of fired clay effect. The paint is suitable on metal, wood, stone, concrete, clay, cardboard, glass and plastic objects. It gives the object a genuine looking satin clay earthenware effect. It forms a strong, weather and UV resistant surface. Maston TerraCotta spray paint reaches a surface hardness comparable to any outdoor paint.

MATERIAL

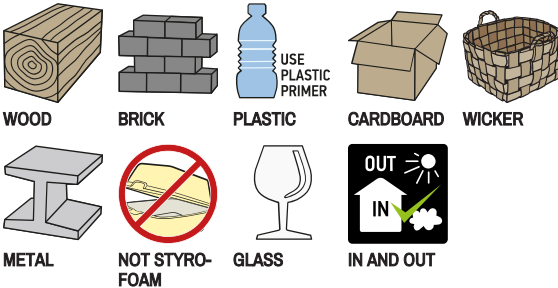

BINDER: Acryl

DEGREE OF GLOSS (DIN 67530 60 °):
satin 45 gloss units

HEAT RESISTANCE: 110°C

STORAGE STABILITY: 60 months

SIZE: 400ml

HARDNESS



SALES QTY:

400ml: 6 pcs

RECOAT:

always

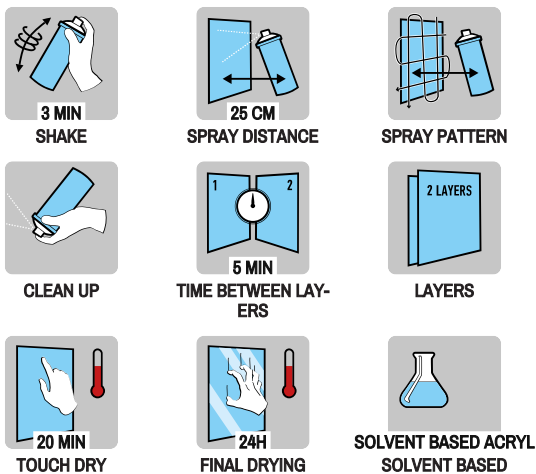

MASTON Terracotta effect

Art. No.	MASTON Terracotta effect	Color	Barcode
831001			6412490036942